

TUBE END FACING MACHINE - PIPE BEVELLER - 18000

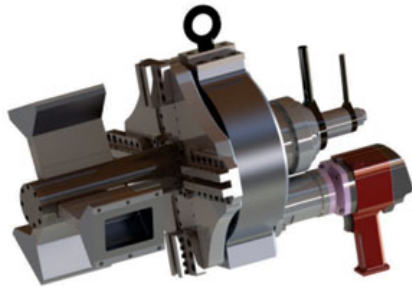

FMP - 18000 PNEUMATIC

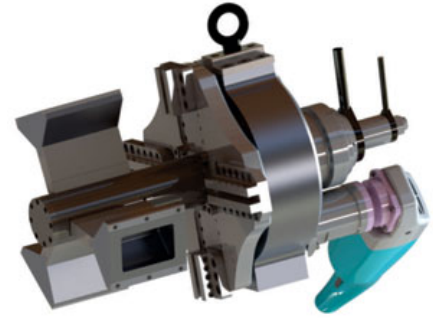

FME - 18000 ELECTRIC

FEATURES OF THE TUBE END FACING MACHINE - FM-18000

TOOL HOLDER - Holds the cutting tool bits tightly at the desired position. Its robust construction and support to the cutting bits ensure vibration free performance.

CENTRAL MANDREL - Expanding mandrel allows fast, accurate and self-centering alignment with torque-free operation for operator safety.

FEED SHAFT - High strength, precise machined and hardened feed shaft provides powerful feeding to the assembly which slides over it.

PNEUMATIC OR ELECTRIC DRIVE - High quality pneumatic or electric drive for reliable service and long working life.

JAW - Wedge type hardened tool steel mounted jaws for maximum life and secure positioning. Available within the locking range of 102mm to 457mm.

BODY - Light weight, high pressure cast aluminum body allows continuous operation under the harshest conditions.

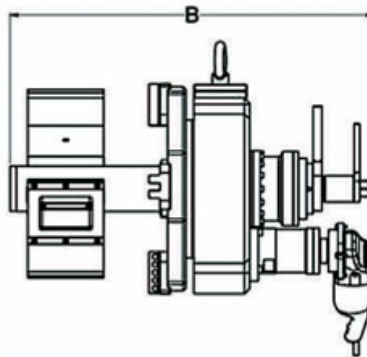
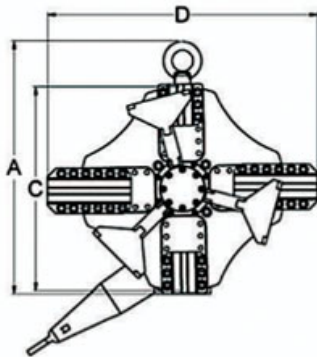

	PNEUMATIC (mm)	ELECTRIC (mm)
A	476	476
B	686	686
C	385	385
D	508	508

Drive		Pneumatic	Electric
Locking Range	mm (inch)	102 - 457 (4" - 18")	102 - 457 (4" - 18")
Ideal Speed	RPM	15	15
Torque	Nm (lb.ft)	1266 (933)	1182 (871)
Feeding Stroke	mm (inch)	60 (2.36")	60 (2.36")
Pneumatic Power	HP	3.5	-
Air Consumption	cfm	85	-
Air Pressure	Bar (psi)	6.2 (90)	-
Electric Power	watts	-	2600
Voltage	V	-	230
Net Weight	kg (lb)	90 (198)	90 (198)